

UKFC
Tapered bore (with adapter)
 d_1 70 ~ 90 mm

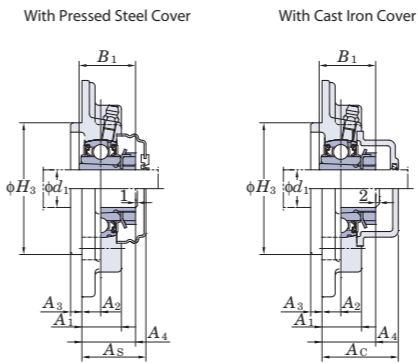
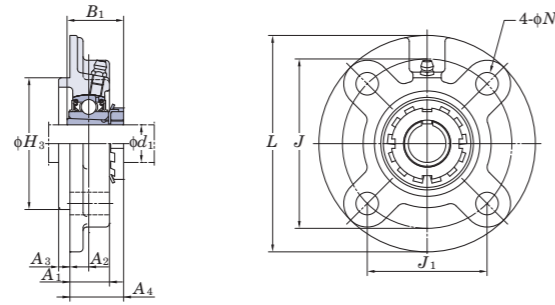

Variations of tolerance of spigot joint outside diameter (ΔH_{3s}), variations of tolerance of distance from mounting surface to center of spherical bore (ΔA_{2s}), tolerance of position of bolt hole (X), and tolerance of circumferential runout of spigot joint (Y)

Housing No.	ΔH_{3s}	ΔA_{2s}	X	Y
FC205~FC206 FCX05	0 -0.046	±0.5	0.7	0.2
FC207~FC210 FCX06~FCX10	0 -0.054			
FC211~FC217 FCX11~FCX15	0 -0.063	±0.8	1	0.3
FC218 FCX16~FCX18 FCX20	0 -0.072			

Unit: mm

Variations of tolerance of bolt hole diameter (ΔH_{1s})

Housing No.	ΔH_{1s}
FC204~FC218 FCX05~FCX20	±0.2

Unit: mm

Shaft Dia. mm inch d_1	Dimensions inch mm										Bolt Size inch mm	Standard			Adapter No.	Mass kg	Basic Load Ratings kN		Factor f_0	With Pressed Steel Cover				With Cast Iron Cover											
	L	H ₃	J	J ₁	N	A ₁	A ₂	A ₃	A ₄	B ₁		Unit No.	Housing No.	Bearing No.			Unit No. Open Type Closed Type	Dimension mm inch A _s		Mass kg	Unit No. Open Type Closed Type	Dimension mm inch A _c	Mass kg												
70 2 3/4	9 7/16	6.6929	7 7/8	5 9/16	29/32	1 31/32	45/64	5/8	2 15/32	3 1/16	3/4	UKFC216	FC216	UK216	HE2316X H2316X	9.0 9.0	72.7 53.0	14.6	-	-	-	-	-	-	-	-	-	-	-	-	-	-	-	-	-
	10 1/4	7.3228	8 5/8	6 3/32	29/32	1 13/32	25/64	63/64	1 15/16	3 1/16	3/4	UKFCX16	FCX16	UKX16	HE2316X H2316X	11.4 11.4	84.0 61.9	14.5	UKFC216C UKFC216D	UKFC216C UKFC216D	72.5 2 27/32	9.0	UKFC216FC UKFC216FD	UKFC216FC UKFC216FD	87 3 7/16	10.3									
75 3	9 27/32	7.0866	8 3/16	5 51/64	29/32	1 25/32	45/64	45/64	3 17/32	3 7/32	3/4	UKFC217	FC217	UK217	H2317X HE2317X	10.4 10.4	84.0 61.9	14.5	UKFC217C UKFC217D	UKFC217C UKFC217D	66.5 2 5/8	11.4	UKFC217FC UKFC217FD	UKFC217FC UKFC217FD	89 3 1/2	11.8									
	10 1/4	7.3228	8 5/8	6 3/32	29/32	1 13/32	25/64	63/64	2 1/16	3 7/32	3/4	UKFCX17	FCX17	UKX17	H2317X HE2317X	12.6 12.6	96.1 71.5	14.5	UKFCX17C UKFCX17D	UKFCX17C UKFCX17D	71.5 2 13/16	12.6	-	-	-	-	-	-	-	-	-	-	-		
80 -	10 7/16	7.4803	8 21/32	6 1/8	29/32	1 31/32	55/64	45/64	2 13/16	3 3/8	3/4	UKFC218	FC218	UK218	H2318X	13.3	96.1 71.5	14.5	UKFC218C UKFC218D	UKFC218C UKFC218D	83.5 3 9/32	13.3	UKFC218FC UKFC218FD	UKFC218FC UKFC218FD	98 3 27/32	14.9									
	10 1/4	7.3228	8 5/8	6 3/32	29/32	1 11/16	15/32	1 7/64	2 5/32	3 3/8	3/4	UKFCX18	FCX18	UKX18	H2318X	13.0	109 81.9	14.4	-	-	-	-	UKFCX18C UKFCX18D	UKFCX18C UKFCX18D	92 3 5/8	15.1									
90 3 1/2	10 7/8	8.1102	9 3/8	6 5/8	29/32	2 19/32	55/64	1 7/64	2 23/32	3 13/16	3/4	UKFCX20	FCX20	UKX20	HE2320X H2320X	17.1 17.1	133 105	14.4	-	-	-	-	UKFCX20C UKFCX20D	UKFCX20C UKFCX20D	116 4 9/16	19.9									
	276	206	238	168.3	23	66	22	28	69	97	M20																								

Remarks 1. In Part No. of unit and units with covers, fitting codes follow bore diameter numbers. (See Table 10.5 in P.62.)
2. Part No. of applicable grease fittings are shown below.
A-1/4-28UNF 205~210, X05~X09
A-R1/8 211~218, X10~X20

3. In Part No. of unit with adapters and bearing with adapters, Part No. of applicable adapter follow the Part No. shown in the dimensional tables. (Example of Part No. : UKFC206J + H2306X, UK206 + H2306X)
4. As for the triple seal type product (205 is the double seal type product), suffix code L3 (or L2) follows the Part No. of unit or bearing. (Example of Part No. : UKFC206JL3 + H2306X, UK206L3 + H2306X)
5. For the dimensions and forms of applicable bearings and adapters, see the dimensional tables of ball bearing for unit and adapter.
6. Housings of nodular graphite cast iron are also available.