

UKFL
Tapered bore (with adapter)
 d_1 20 ~ 50 mm

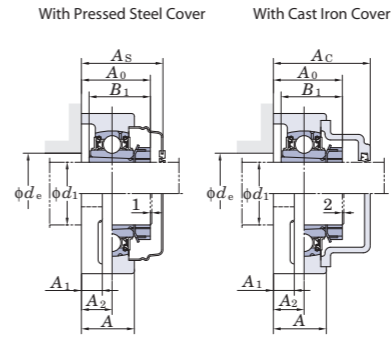
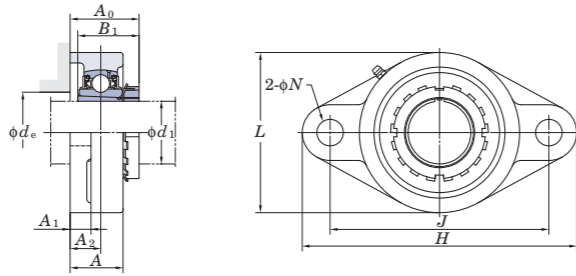

Variations of tolerance of distance from mounting surface to center of spherical bore (ΔA_{2a}) and tolerance of position of bolt hole (X)

Housing No.			ΔA_{2a}	X
FL205~FL210	FLX05~FLX10	FL305~FL310	±0.5	0.7
FL211~FL218		FL311~FL324	±0.8	1

Variations of tolerance of bolt hole diameter (ΔN_b)

Housing No.			ΔN_b
FL205~FL218	FLX05~FLX10	FL305~FL311	±0.2
		FL312~FL324	±0.3

Forms and dimensions of L_c of FL205JE3 (housing with cast iron cover) are shown below.

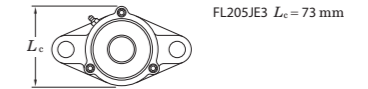

Shaft Dia. mm inch	Dimensions inch mm										Bolt Size inch mm	Standard			Adapter No.	Mass kg	Basic Load Ratings kN			Factor f_0	With Pressed Steel Cover			With Cast Iron Cover			
	d_1	H	L	A	J	N	A ₁	A ₂	A ₀	B ₁		d_e (min.)	Unit No.	Housing No.			Bearing No.	C _r	C _{0r}		Unit No. Open Type Closed Type	Dimension mm inch	Mass kg	Unit No. Open Type Closed Type	Dimension mm inch	Mass kg	
20	3/4	5 1/8	2 11/16	1 1/16	3 57/64	5/8	1/2	5/8	1 13/32	1 3/8	1 3/16	1/2	UKFL205	FL205	UK205	HE2305X H2305X	0.68 0.68	14.0 7.85	13.9	- -	- -	- -	- -	- -	- -	- -	- -
		130	68	27	99	16	13	16	36	35	30	M14	UKFL205C	UKFL205D	40.5 1 19/32	0.68	UKFL205FC	UKFL205FD	49 1 15/16	0.89							
	3/4	5 9/16	3 9/32	1 3/16	4 39/64	15/32	1/2	45/64	1 9/16	1 3/8	1 3/16	3/8	UKFLX05	FLX05	UKX05	HE2305X H2305X	1.0 1.0	19.5 11.3	13.9	- -	- -	- -	- -	- -	- -	- -	
25	3/4	5 29/32	3 5/32	1 5/32	4 29/64	3/4	1/2	5/8	1 15/32	1 3/8	-	5/8	UKFL305	FL305	UK305	HE2305X H2305X	1.1 1.1	21.2 10.9	12.6	- -	- -	- -	- -	- -	- -	- -	
		150	80	29	113	19	13	16	37.5	35	-	M16	UKFL305C	UKFL305D	54 2 1/8	1.4	UKFL305FC	UKFL305FD	53 2 3/32	1.2							
	1	5 13/16	3 5/32	1 7/32	4 39/64	5/8	1/2	45/64	1 9/16	1 1/2	1 13/32	3/8	UKFL206	FL206	UK206	H2306X HE2306X	0.97 0.97	19.5 11.3	13.9	UKFL206C	UKFL206D	44.5 1 3/4	0.97	UKFL206FC	UKFL206FD	53 2 3/32	1.2
30	1 1/8	6 5/32	3 3/4	1 11/32	5 1/8	5/8	9/16	3/4	1 21/32	1 1/2	1 13/32	3/8	UKFLX06	FLX06	UKX06	H2306X HE2306X	1.5 1.5	25.7 15.4	13.9	UKFLX06C	UKFLX06D	49 1 15/16	1.5	- -	- -	- -	- -
		156	95	34	130	16	14	19	42	38	36	M14	UKFL306	FL306	UK306	H2306X HE2306X	1.5 1.5	26.7 15.0	13.3	- -	- -	- -	- -	- -	- -		
	1	7 3/32	3 17/32	1 1/4	5 9/32	29/32	19/32	45/64	1 5/8	1 1/2	-	3/4	UKFL207	FL207	UK207	H2307X H2307X	1.3 1.3	25.7 15.4	13.9	- -	- -	- -	- -	- -	- -	- -	
35	1 1/4	6 11/32	3 17/32	1 11/32	5 1/8	5/8	9/16	3/4	1 11/16	1 11/16	1 5/8	3/8	UKFLX07	FLX07	UKX07	H2307X H2307X	1.8 1.8	29.1 17.8	14.0	- -	- -	- -	- -	- -	- -	- -	
		171	105	38	144	16	14	21	47	43	41	M14	UKFL307	FL307	UK307	H2307X H2307X	1.9 1.9	33.4 19.3	13.2	- -	- -	- -	- -	- -	- -	- -	
	1 1/8	7 9/32	3 15/16	1 13/32	5 35/64	29/32	19/32	45/64	1 5/8	1 11/16	-	3/4	UKFL208	FL208	UK208	HE2308X H2308X	1.6 1.6	29.1 17.8	14.0	UKFL208C	UKFL208D	55.5 2 3/16	1.8	UKFL208FC	UKFL208FD	64 2 17/32	2.0
40	1 1/4	7 1/16	4 3/8	1 9/16	5 53/64	5/8	9/16	55/64	1 31/32	1 13/16	1 13/16	3/8	UKFLX08	FLX08	UKX08	HE2308X H2308X	2.1 2.1	34.1 21.3	14.0	- -	- -	- -	- -	- -	- -	- -	
		179	111	40	148	16	14	22	50	46	46	M14	UKFL308	FL308	UK308	HE2308X H2308X	2.5 2.5	40.7 24.0	13.2	- -	- -	- -	- -	- -	- -	- -	
	1 3/8	7 7/8	4 13/32	1 9/16	6 7/32	29/32	21/32	29/32	2	1 13/16	-	3/4	UKFL209	FL209	UK209	HE2309X H2309X	2.0 2.0	34.1 21.3	14.0	- -	- -	- -	- -	- -	- -	- -	
45	1 1/2	7 7/16	4 9/16	1 9/16	6 3/16	5/8	9/16	29/32	2 1/16	1 31/32	2 1/16	3/8	UKFLX09	FLX09	UKX09	HE2309X H2309X	2.5 2.5	35.1 23.3	14.4	UKFL209C	UKFL209D	56.5 2 7/32	2.0	UKFL209FC	UKFL209FD	66 2 19/32	2.5
		189	116	40	157	16	14	23	52	50	52	M14	UKFL309	FL309	UK309	HE2309X H2309X	3.6 3.6	48.9 29.5	13.3	- -	- -	- -	- -	- -	- -	- -	
	1 3/4	7 3/4	4 17/32	1 9/16	6 3/16	3/4	19/32	55/64	2 1/16	2 5/32	2 9/32	5/8	UKFL210	FL210	UK210	HE2310X H2310X	2.3 2.3	35.1 23.3	14.4	- -	- -	- -	- -	- -	- -	- -	
50	1 7/8	8 13/16	5 1/8	1 11/16	7 1/4	3/4	23/32	63/64	2 1/4	2 5/16	2 17/32	5/8	UKFLX10	FLX10	UKX10	HE2310X H2310X	3.7 3.7	43.4 29.4	14.4	UKFL210C	UKFL210D	59 2 5/16	2.3	UKFL210FC	UKFL210FD	70.5 2 25/32	2.8
		216	133	44	184	19	20	26	58	55	58	M16	UKFL310	FL310	UK310	HE2310X H2310X	4.4 4.4	62.0 38.3	13.2	- -	- -	- -	- -	- -	- -	- -	
	1 3/4	9 7/16	5 1/2	1 7/8	7 23/64	63/64	3/4	1 7/64	2 3/8	2 5/32	-	7/8	UKFL211	FL211	UK211	HE2311X H2311X	3.3 3.3	43.4 29.4	14.4	- -	- -	- -	- -	- -	- -	- -	
2	1 7/8	8 27/32	5 29/32	2 1/16	7 51/64	63/64	25/32	1 3/16	2 17/32	2 5/16	-	7/8	UKFL311	FL311	UK311	HE2311X H2311X	5.6 5.6	71.6 45.0	13.2	UKFL211C	UKFL211D	63 2 15/32	3.3	UKFL211FC	UKFL211FD	74.5 2 15/16	3.9
		250	150	52	198	25	20	30	64	59	-	M22															

Remarks 1. In Part No. of unit and units with covers, fitting codes follow bore diameter numbers. (See Table 10.5 in P.62.)
2. Part No. of applicable grease fittings are shown below.
A-1/4-28UNF 205~210, X05~X09, 305~308
A-R1/8 211~218, X10, 309~324

3. In Part No. of unit with adapters and bearing with adapters, Part No. of applicable adapter follow the Part No. shown in the dimensional tables. (Example of Part No.: UKFL206J + H2306X, UK206 + H2306X)
4. As for the triple seal type product (205 is the double seal type product), suffix code L3 (or L2) follows the Part No. of unit or bearing. (Example of Part No.: UKFL206JL3 + H2306X, UK206L3 + H2306X)
5. For the dimensions and forms of applicable bearings and adapters, see the dimensional tables of ball bearing for unit and adapter.
6. Housings of nodular graphite cast iron are also available.