

UCHA
Cylindrical bore (with set screws)
d 12 ~ 75 mm

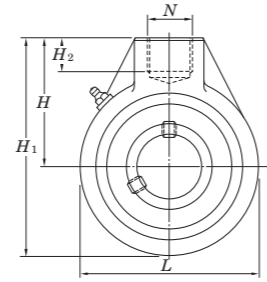
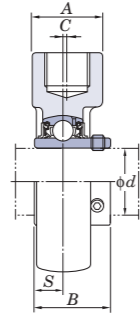

Note 1) Dimensions N screw hole is apply JIS B0203 (Taper Pipe Threads) standards.
It can not apply to the Parallel Pipe Male Thread.
Also, below shown the dimensions of Parallel Pipe Female Thread.

Nominal of Thread	Female Thread			Thread	Apply Male Thread
	Major Diameter	Pitch Diameter	Minor Diameter	Number of Threads (in 25.4 mm)	
	D	D ₂	D ₁	n	
Rp 3/4	26.441	25.279	24.117	14	R 3/4
Rp 1	33.249	31.770	30.291	11	R 1
Rp 1 1/2	41.910	40.431	38.952	11	R 1 1/2
Rp 1 1/4	47.803	46.324	44.845	11	R 1 1/4

Shaft Dia. mm inch	Dimensions inch mm									Unit No.	Housing No.	Bearing No.	Basic Load Ratings kN		Factor f ₀	Mass kg	
	d	H	A	L	H ₁	H ₂	N ¹⁾	C	B				S	C _r			C _{0r}
12 1/2											UCHA201 UCHA201-8 UCHA202	HA204	UC201 UC201-8 UC202	12.8	6.65	13.2	0.77 0.75
15 5/8	2 17/32	1 9/16	2 17/32	3 25/32	3/4	Rp 3/4	-	1.220	0.500		UCHA202-10 UCHA203 UCHA204-12 UCHA204		UC202-10 UC203 UC204-12 UC204				0.74 0.72
17 3/4	64	40	64	96	19			31	12.7								
20											UCHA205-14 UCHA205-15 UCHA205 UCHA205-16	HA205	UC205-14 UC205-15 UC205 UC205-16	14.0	7.85	13.9	0.87
25 7/8 15/16	2 17/32	1 9/16	3 1/16	4 1/16	3/4	Rp 3/4	-	1.343	0.563		UCHA206-18 UCHA206 UCHA206-19 UCHA206-20	HA206	UC206-18 UC206 UC206-19 UC206-20	19.5	11.3	13.9	0.83
30 1 1 1/8 1 3/16 1 1/4	2 17/32	1 9/16	3 1/16	4 1/16	3/4	Rp 3/4	-	1.500	0.626		UCHA207-20 UCHA207-21 UCHA207-22 UCHA207 UCHA207-23	HA207	UC207-20 UC207-21 UC207-22 UC207 UC207-23	25.7	15.4	13.9	1.2
35 1 5/16 1 3/8 1 7/16	2 3/4	1 9/16	3 5/8	4 9/16	3/4	Rp 3/4	-	1.689	0.689		UCHA208-24 UCHA208-25 UCHA208	HA208	UC208-24 UC208-25 UC208	29.1	17.8	14.0	1.3
40 1 1/2 1 9/16	2 7/8	1 9/16	3 25/32	4 3/4	3/4	Rp 3/4	5/64	1.937	0.748		UCHA209-26 UCHA209-27 UCHA209-28 UCHA209	HA209	UC209-26 UC209-27 UC209-28 UC209	34.1	21.3	14.0	1.7
45 1 5/8 1 11/16 1 3/4	3 7/32	1 7/8	4 1/4	5 11/32	13/16	Rp 1	13/64	1.937	0.748		UCHA210-30 UCHA210-31 UCHA210 UCHA210-32	HA210	UC210-30 UC210-31 UC210 UC210-32	35.1	23.3	14.4	2.1
50 1 7/8 1 15/16 2	3 9/32	1 7/8	4 21/32	5 19/32	13/16	Rp 1	13/64	2.031	0.748		UCHA211-32 UCHA211-34 UCHA211 UCHA211-35	HA211	UC211-32 UC211-34 UC211 UC211-35	43.4	29.4	14.4	2.8
55 2 2 1/8 2 3/16	3 7/16	2 3/8	4 31/32	5 29/32	31/32	Rp 1 1/4	9/32	2.189	0.874		UCHA212-36 UCHA212 UCHA212-38 UCHA212-39	HA212	UC212-36 UC212 UC212-38 UC212-39	52.4	36.2	14.4	3.9
60 2 3/8 2 7/16	4 1/32	2 3/8	5 19/32	6 13/16	1 3/32	Rp 1 1/4	23/64	2.563	1.000		UCHA213-40 UCHA213 UCHA214-44 UCHA214	HA213	UC213-40 UC213 UC214-44 UC214	57.2	40.1	14.4	5.8
65 2 1/2	4 19/32	2 3/4	6 17/32	7 7/8	1 1/4	Rp 1 1/2	3/8	2.563	1.000		UCHA215-47 UCHA215 UCHA215-48	HA215	UC215-47 UC215 UC215-48	67.4	48.3	14.5	5.6
70 2 3/4	4 19/32	2 3/4	6 17/32	7 7/8	1 1/4	Rp 1 1/2	3/8	2.937	1.189				UC214-44 UC214	62.2	44.1	14.5	5.9
75 2 15/16 3	4 19/32	2 3/4	6 17/32	7 7/8	1 1/4	Rp 1 1/2	3/8	3.063	1.311					67.4	48.3	14.5	5.6

Remarks 1. In Part No. of unit and units with covers, fitting codes follow bore diameter numbers. (See Table 10.5 in P.62.)
2. Part No. of applicable grease fittings are shown below.
A-1/4-28UNF 201~210
A-R1/8..... 211~215

3. As for the triple seal type product (from 201 to 205 are the double seal type products), suffix code L3 (or L2) follows the Part No. of unit or bearing. (Example of Part No. : UCHA206JL3, UC206L3)
4. For the dimensions and forms of applicable bearings and adapters, see the dimensional tables of ball bearing for unit and adapter.
5. Tapered bore (with adapter) type products are also available. (Example of Part No. : UKHA205J + H2305X, UK205 + H2305X)